

# Panasonic Self Help Guides



## 2010 TV Retuning Guide

In order to receive all of the available digital channels it will be necessary to retune your TV. Using the Auto-Setup function is the simplest method for doing this. The Auto-Setup instructions contained in this guide are applicable to the following models:

### Model List:

Plasma: TXP65/50/46/42VT20, TXP42GT20, TXP50/42V20, TXP50/46/42G20,  
TXP50/46/42S20, TXP50/42/37X20

LCD: TXL37V20, TXL37/32/22/19D28, TXL42/37/32D25, TXL37/32G20,  
TXL37/32S20, TXL32/26/22X20, txl19C20

# Panasonic

ideas for life

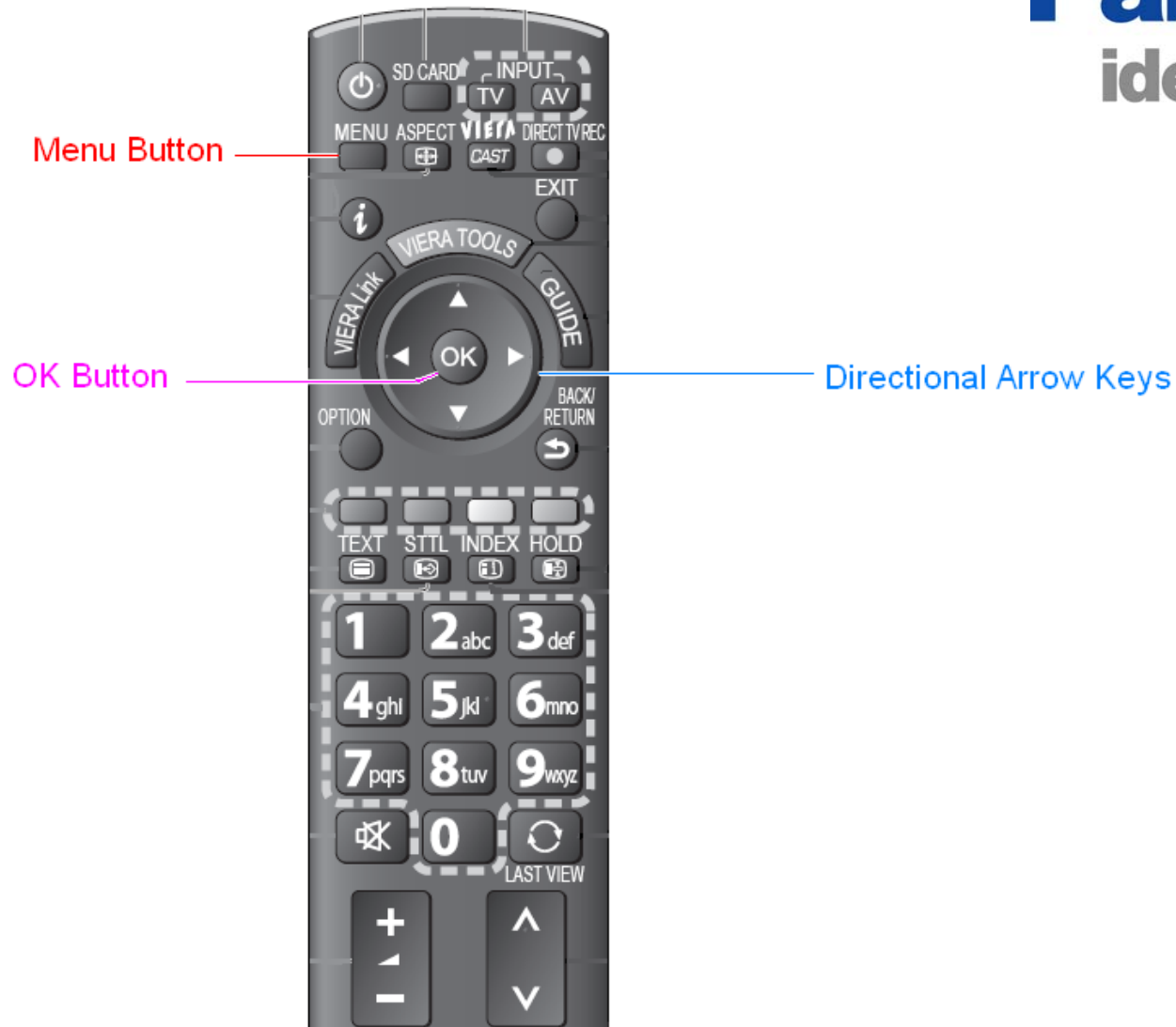

# Auto-Setup

**Panasonic**  
ideas for life

Restarting auto set-up will retune the unit and will find all of the TV stations currently being received. It will also reset the time and date. Unlike Shipping condition, no other settings will be affected.

You will see

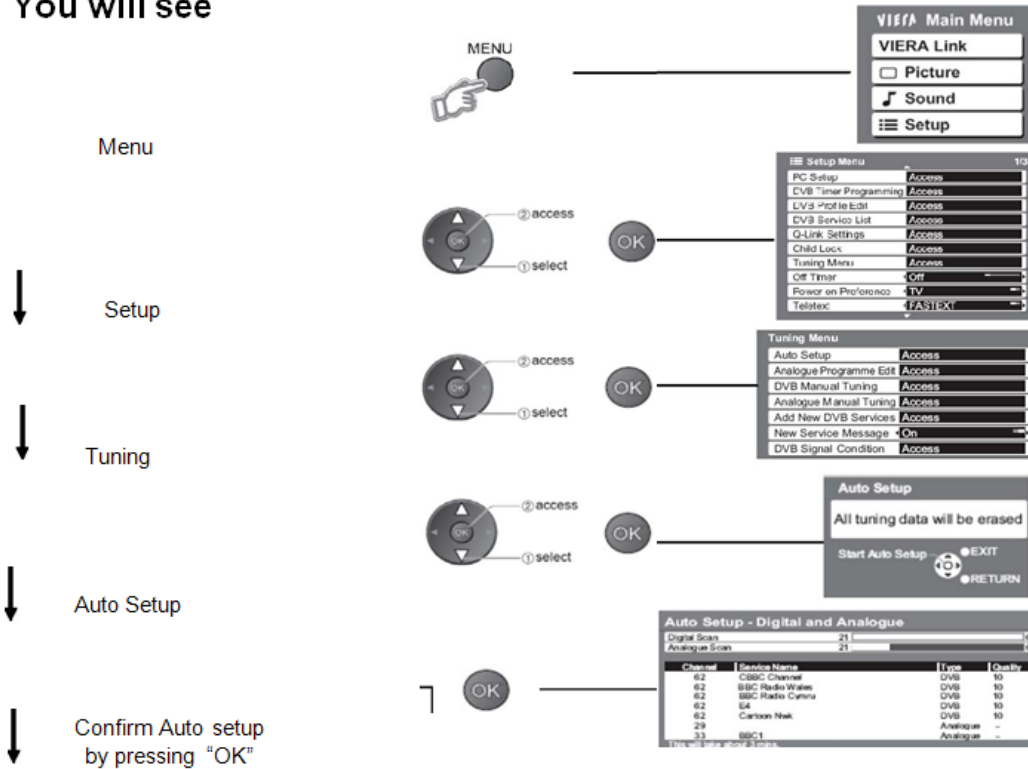

# Auto-Setup Continued...

**Panasonic**  
ideas for life

## Auto-set-up Begins....

### Start Auto Setup



### Settings are made automatically

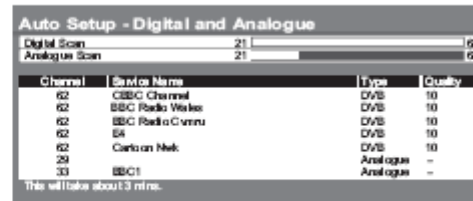

- All previous settings are erased.
- The analogue settings are downloaded to a Q-Link compatible equipment connected to the TV.

- When the operation is completed, the digital service at programme position "1" will be displayed. If no DVB services are found, the first analogue service will be displayed.

The process will take between 3 and 5 minutes to complete.  
Please do not press any button until complete.

A TV station will appear when once tuning has finished.